







APN

Where precision and value take form

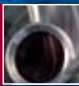

STANDARD AND CUSTOM STAINLESS STEEL TUBE FITTINGS

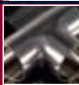
SANITARY BUTTWELD FITTINGS

CONTENTS		Bevel Seat Fittings
		BPE Fittings
		Clamp Fittings
		I-Line Fittings
		John Perry Fittings
		Sanitary Buttweld Fittings
		Tube O.D. Fittings

Call toll-free to order: 877.276.7766 • www.apn-inc.net

2S

90° Butt weld Elbow with Tangents, #7 finish 3-A

304 Item Number	Tube O.D.	A	Nominal Wall Thickness	316L Item Number
2S-0075-7-4	.75	1.42	0.065	2S-0075-7-6
2S-0100-7-4	1	2.062	0.065	2S-0100-7-6
2S-0150-7-4	1.5	2.937	0.065	2S-0150-7-6
2S-0200-7-4	2	4.062	0.065	2S-0200-7-6
2S-0250-7-4	2.5	5.187	0.065	2S-0250-7-6
2S-0300-7-4	3	6.312	0.065	2S-0300-7-6
2S-0400-7-4	4	8.312	0.083	2S-0400-7-6

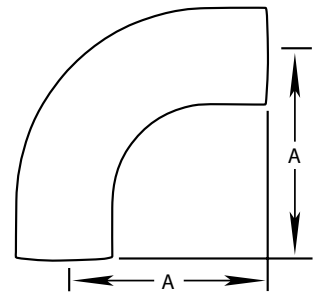

2WCL

90° Butt weld Elbow, #7 finish 3-A

304 Item Number	Tube O.D.	A	Nominal Wall Thickness	316L Item Number
2WCL-0075-7-4	.75	1.125	0.065	2WCL-0075-7-6
2WCL-0100-7-4	1	1.5	0.065	2WCL-0100-7-6
2WCL-0125-7-4	1.25	1.875	0.065	2WCL-0125-7-6
2WCL-0150-7-4	1.5	2.250	0.065	2WCL-0150-7-6
2WCL-0200-7-4	2	3.00	0.065	2WCL-0200-7-6
2WCL-0250-7-4	2.5	3.7	0.065	2WCL-0250-7-6
2WCL-0300-7-4	3	4.50	0.065	2WCL-0300-7-6
2WCL-0400-7-4	4	6.00	0.083	2WCL-0400-7-6
2WCL-0600-7-4	6	9.000	0.109	2WCL-0600-7-6

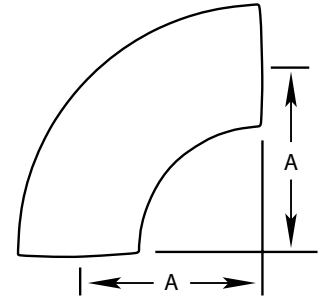

2CM

90° Clamp x Butt weld Elbow, #7 finish 3-A

304 Item Number	Tube O.D.	A	B	Nominal Wall Thickness	316L Item Number
2CM-0100-7-4	1	2.062	2.562	0.065	2CM-0100-7-6
2CM-0150-7-4	1.5	2.937	3.438	0.065	2CM-0150-7-6
2CM-0200-7-4	2	4.062	4.562	0.065	2CM-0200-7-6
2CM-0250-7-4	2.5	5.187	5.688	0.065	2CM-0250-7-6
2CM-0300-7-4	3	6.312	6.812	0.065	2CM-0300-7-6
2CM-0400-7-4	4	8.312	8.937	0.083	2CM-0400-7-6
2CM-0600-7-4	6	N/A	N/A	N/A	2CM-0600-7-6

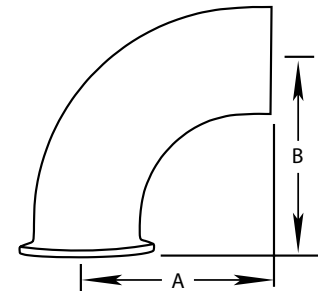

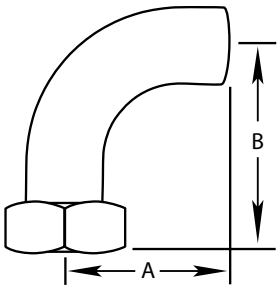
**2FP****90° Plain Bevel Seat with Hex Nut x Butt Weld Elbow, #7 finish 3-A**

304 Item Number	Tube O.D.	A	B	Nominal Wall Thickness	316L Item Number
2FP-0100-7-4	1	2.062	2.780	0.065	2FP-0100-7-6
2FP-0150-7-4	1.5	2.937	3.656	0.065	2FP-0150-7-6
2FP-0200-7-4	2	4.062	4.781	0.065	2FP-0200-7-6
2FP-0250-7-4	2.5	5.187	6.031	0.065	2FP-0250-7-6
2FP-0300-7-4	3	6.312	7.218	0.065	2FP-0300-7-6
2FP-0400-7-4	4	8.312	9.531	0.083	2FP-0400-7-6

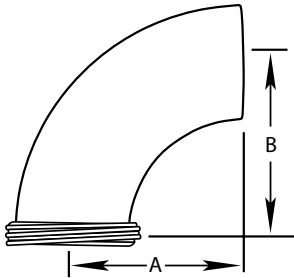
2T**90° Threaded Bevel Seat x Butt Weld Elbow, #7 finish 3-A**

304 Item Number	Tube O.D.	A	B	Nominal Wall Thickness	316L Item Number
2T-0100-7-4	1	2.062	2.780	0.065	2T-0100-7-6
2T-0150-7-4	1.5	2.937	3.656	0.065	2T-0150-7-6
2T-0200-7-4	2	4.062	4.781	0.065	2T-0200-7-6
2T-0250-7-4	2.5	5.187	6.031	0.065	2T-0250-7-6
2T-0300-7-4	3	6.312	7.218	0.065	2T-0300-7-6
2T-0400-7-4	4	8.312	9.531	0.083	2T-0400-7-6

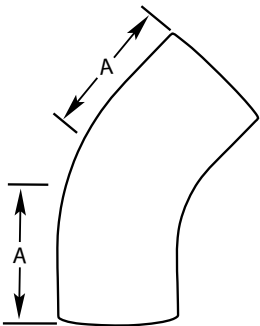
2KS**45° Butt Weld Elbow with Tangents, #7 Finish 3-A**

304 Item Number	Tube O.D.	A	Nominal Wall Thickness	316L Item Number
2KS-0100-7-4	1	1.187	0.065	2KS-0100-7-6
2KS-0150-7-4	1.50	1.625	0.065	2KS-0150-7-6
2KS-0200-7-4	2	2.312	0.065	2KS-0200-7-6
2KS-0250-7-4	2.50	3.000	0.065	2KS-0250-7-6
2KS-0300-7-4	3	3.688	0.065	2KS-0300-7-6
2KS-0400-7-4	4	4.812	0.083	2KS-0400-7-6

2WK

45° Butt Weld Elbow, #7 Finish 3-A

304 Item Number	Tube O.D.	A	Nominal Wall Thickness	316L Item Number
2WK-0100-7-4	1	0.625	0.065	2WK-0100-7-6
-	1.25	0.718	0.065	2WK-0125-7-6
2WK-0150-7-4	1.50	0.937	0.065	2WK-0150-7-6
2WK-0200-7-4	2	1.250	0.065	2WK-0200-7-6
2WK-0250-7-4	2.50	1.562	0.065	2WK-0250-7-6
2WK-0300-7-4	3	1.875	0.065	2WK-0300-7-6
2WK-0400-7-4	4	2.500	0.083	2WK-0400-7-6
2WK-0600-7-4	6	3.750	0.109	2WK-0600-7-6

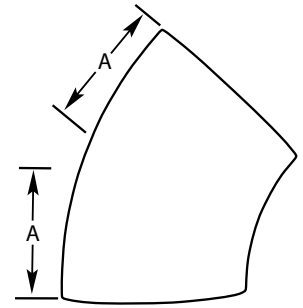

2KM

45° Clamp x Butt Weld Elbow, #7 Finish 3-A

304 Item Number	Tube O.D.	A	B	Nominal Wall Thickness	316L Item Number
2KM-0100-7-4	1	1.188	1.688	0.065	2KM-0100-7-6
2KM-0150-7-4	1.5	1.625	2.125	0.065	2KM-0150-7-6
2KM-0200-7-4	2	2.312	2.812	0.065	2KM-0200-7-6
2KM-0250-7-4	2.5	3.000	3.500	0.065	2KM-0250-7-6
2KM-0300-7-4	3	3.688	4.188	0.065	2KM-0300-7-6
2KM-0400-7-4	4	4.812	5.437	0.083	2KM-0400-7-6

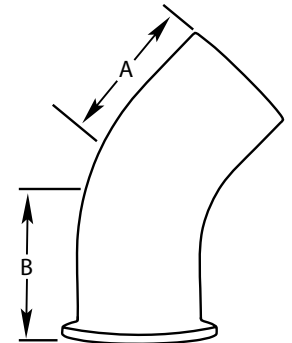

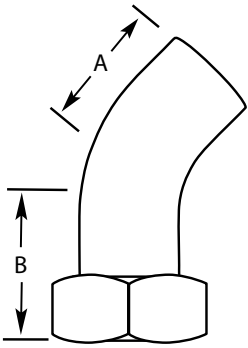
**2KP****45° Plain Bevel Seat with Hex Nut x Butt Weld Elbow, #7 Finish 3-A**

304 Item Number	Tube O.D.	A	B	Nominal Wall Thickness	Description	316L Item Number
2KP-0100-7-4	1	1.188	1.875	0.065	Hex Nut is 304 only	2KP-0100-7-6
2KP-0150-7-4	1.5	1.625	2.343	0.065	Hex Nut is 304 only	2KP-0150-7-6
2KP-0200-7-4	2	2.312	3.031	0.065	Hex Nut is 304 only	2KP-0200-7-6
2KP-0250-7-4	2.5	3.000	3.843	0.065	Hex Nut is 304 only	2KP-0250-7-6
2KP-0300-7-4	3	3.688	4.594	0.065	Hex Nut is 304 only	2KP-0300-7-6
2KP-0400-7-4	4	4.812	6.031	0.083	Hex Nut is 304 only	2KP-0400-7-6

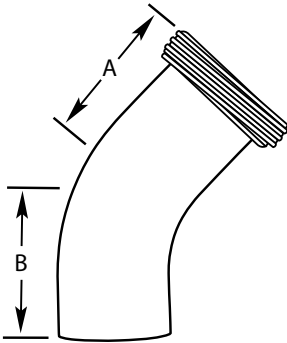
2KT**45° Threaded Bevel Seat x Butt Weld Elbow, #7 Finish 3-A**

304 Item Number	Tube O.D.	A	B	Nominal Wall Thickness	316L Item Number
2KT-0100-7-4	1	1.188	1.875	0.065	2KT-0100-7-6
2KT-0150-7-4	1.5	1.625	2.343	0.065	2KT-0150-7-6
2KT-0200-7-4	2	2.312	3.031	0.065	2KT-0200-7-6
2KT-0250-7-4	2.5	3.000	3.843	0.065	2KT-0250-7-6
2KT-0300-7-4	3	3.688	4.594	0.065	2KT-0300-7-6
2KT-0400-7-4	4	4.812	6.031	0.083	2KT-0400-7-6

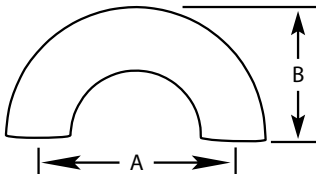
2WUL**180° Butt Weld Return Bend, #7 finish 3-A**

304 Item Number	Tube O.D.	A	B	Nominal Wall Thickness	316L Item Number
2WUL-0100-7-4	1	3.0	2.0	0.065	2WUL-0100-7-6
2WUL-0150-7-4	1.5	4.5	3.0	0.065	2WUL-0150-7-6
2WUL-0200-7-4	2	6.0	4.0	0.065	2WUL-0200-7-6
2WUL-0250-7-4	2.5	7.5	5.0	0.065	2WUL-0250-7-6
2WUL-0300-7-4	3	9.0	6.0	0.065	2WUL-0300-7-6
2WUL-0400-7-4	4	12.0	8.0	0.083	2WUL-0400-7-6

7WWW

Buttweld Short Tee, #7 Finish 3-A

304 Item Number	Tube O.D.	A	Nominal Wall Thickness	316L Item Number
7WWW-0100-7-4	1	1.125	0.065	7WWW-0100-7-6
7WWW-0150-7-4	1.5	1.656	0.065	7WWW-0150-7-6
7WWW-0200-7-4	2	2.062	0.065	7WWW-0200-7-6
7WWW-0250-7-4	2.5	2.344	0.065	7WWW-0250-7-6
7WWW-0300-7-4	3	2.594	0.065	7WWW-0300-7-6
7WWW-0400-7-4	4	3.438	0.083	7WWW-0400-7-6
7WWW-0600-7-4	6	5.625	0.109	7WWW-0600-7-6

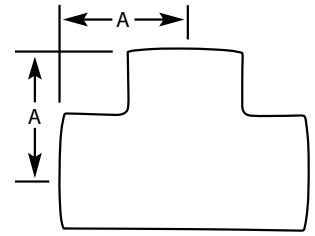

7W

Buttweld Long Tee, #7 Finish 3-A

304 Item Number	Tube O.D.	A	Nominal Wall Thickness	316L Item Number
7W-0100-7-4	1	1.875	0.065	7W-0100-7-6
7W-0150-7-4	1.50	2.250	0.065	7W-0150-7-6
7W-0200-7-4	2	3.000	0.065	7W-0200-7-6
7W-0250-7-4	2.50	3.000	0.065	7W-0250-7-6
7W-0300-7-4	3	3.250	0.065	7W-0300-7-6
7W-0400-7-4	4	3.875	0.083	7W-0400-7-6
7W-0600-7-4	6	5.625	0.109	7W-0600-7-6

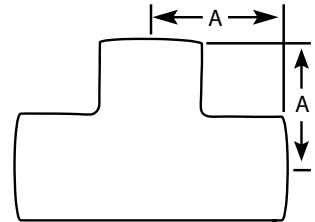

7RWWW

Butt Weld Reducing Tee, #7 Finish 3-A

304 Item Number	Tube O.D.	A	B	C	D	Nominal Wall Thickness	316L Item Number
7RWWW-0150X0100-7-4	1.5 x 1	1.656	1.375	1.5	1.00	0.065	7RWWW-0150X0100-7-6
7RWWW-0200X0100-7-4	2 x 1	2.063	1.625	2.0	1.00	0.065	7RWWW-0200X0100-7-6
7RWWW-0200X0150-7-4	2 x 1.5	2.063	1.906	2.0	1.50	0.065	7RWWW-0200X0150-7-6
7RWWW-0250X0100-7-4	2.5 x 1	2.344	1.875	2.5	1.50	0.065	7RWWW-0250X0100-7-6
7RWWW-0250X0150-7-4	2.5 x 1.5	2.344	2.156	2.5	1.50	0.065	7RWWW-0250X0150-7-6
7RWWW-0250X0200-7-4	2.5 x 2	2.344	2.156	2.5	2.00	0.065	7RWWW-0250X0200-7-6
7RWWW-0300X0100-7-4	3 x 1	2.594	2.406	3.0	1.00	0.065	7RWWW-0300X0100-7-6
7RWWW-0300X0150-7-4	3 x 1.5	2.594	2.406	3.0	1.50	0.065	7RWWW-0300X0150-7-6
7RWWW-0300X0200-7-4	3 x 2	2.594	2.563	3.0	2.00	0.065	7RWWW-0300X0200-7-6
7RWWW-0300X0250-7-4	3 x 2.5	2.594	2.593	3.0	2.50	0.083	7RWWW-0300X0250-7-6
7RWWW-0400X0150-7-4	4 x 1.5	3.438	2.906	4.0	1.50	0.065	7RWWW-0400X0150-7-6
7RWWW-0400X0200-7-4	4 x 2	3.438	3.062	4.0	2.00	0.083	7RWWW-0400X0200-7-6
7RWWW-0400X0250-7-4	4 x 2.5	3.438	3.093	4.0	2.50	0.083	7RWWW-0400X0250-7-6
7RWWW-0400X0300-7-4	4 x 3	3.438	3.093	4.0	3.00	0.083	7RWWW-0400X0300-7-6
7RWWW-0600X0200-7-4	6 x 2	5.625	4.50	6.0	2.00	0.109	7RWWW-0600X0200-7-6
7RWWW-0600X0300-7-4	6 x 3	5.625	4.875	6.0	3.00	0.109	7RWWW-0600X0300-7-6
7RWWW-0600X0400-7-4	6 x 4	5.625	5.125	6.0	4.00	0.109	7RWWW-0600X0400-7-6

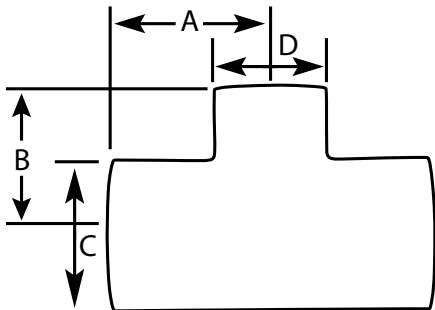

7WWM

Buttweld Run x Clamp Branch Tee, #7 Finish 3-A

304 Item Number	Tube O.D.	A	B	Nominal Wall Thickness	316L Item Number
7WWM-0100-7-4	1	1.125	1.625	0.065	7WWM-0100-7-6
7WWM-0150-7-4	1.5	1.656	2.156	0.065	7WWM-0150-7-6
7WWM-0200-7-4	2	2.062	2.562	0.065	7WWM-0200-7-6
7WWM-0250-7-4	2.5	2.344	2.844	0.065	7WWM-0250-7-6
7WWM-0300-7-4	3	2.594	3.094	0.065	7WWM-0300-7-6
7WWM-0400-7-4	4	3.438	4.063	0.083	7WWM-0400-7-6
7WWM-0600-7-4	6	5.625	6.50	0.109	7WWM-0600-7-6

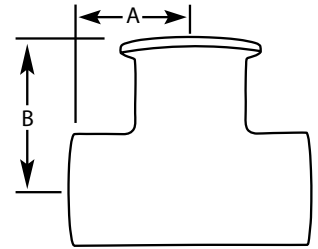

7WMM

Buttweld x Clamp Run x Clamp Branch Tee, #7 Finish 3-A

304 Item Number	Tube O.D.	A	B	Nominal Wall Thickness	316L Item Number
7WMM-0100-7-4	1	1.625	1.125	0.065	7WMM-0100-7-6
7WMM-0150-7-4	1.5	2.156	1.656	0.065	7WMM-0150-7-6
7WMM-0200-7-4	2	2.562	2.062	0.065	7WMM-0200-7-6
7WMM-0250-7-4	2.5	2.844	2.344	0.065	7WMM-0250-7-6
7WMM-0300-7-4	3	3.094	2.594	0.065	7WMM-0300-7-6
7WMM-0400-7-4	4	4.062	3.438	0.083	7WMM-0400-7-6
7WMM-0600-7-4	6	6.50	5.625	0.109	7WMM-0600-7-6

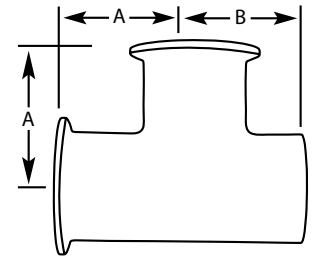

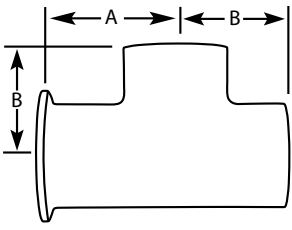
**7WMW****Butt weld x Clamp Run x Butt weld Branch Tee, #7 Finish 3-A**

304 Item Number	Tube O.D.	A	B	Nominal Wall Thickness	316L Item Number
7WMW-0100-7-4	1	1.625	1.125	0.065	7WMW-0100-7-6
7WMW-0150-7-4	1.5	2.156	1.656	0.065	7WMW-0150-7-6
7WMW-0200-7-4	2	2.562	2.062	0.065	7WMW-0200-7-6
7WMW-0250-7-4	2.5	2.844	2.344	0.065	7WMW-0250-7-6
7WMW-0300-7-4	3	3.094	2.594	0.065	7WMW-0300-7-6
7WMW-0400-7-4	4	4.063	3.438	0.083	7WMW-0400-7-6
7WMW-0600-7-4	6	6.50	5.625	0.109	7WMW-0600-7-6

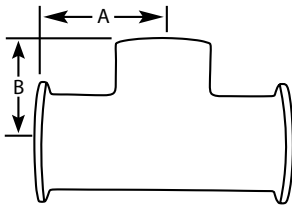
**7MMW****Clamp Run x Butt weld Branch Tee, #7 Finish 3-A**

304 Item Number	Tube O.D.	A	B	Nominal Wall Thickness	316L Item Number
7MMW-0100-7-4	1	1.625	1.125	0.065	7MMW-0100-7-6
7MMW-0150-7-4	1.5	2.156	1.656	0.065	7MMW-0150-7-6
7MMW-0200-7-4	2	2.562	2.062	0.065	7MMW-0200-7-6
7MMW-0250-7-4	2.5	2.844	2.344	0.065	7MMW-0250-7-6
7MMW-0300-7-4	3	3.094	2.594	0.065	7MMW-0300-7-6
7MMW-0400-7-4	4	4.062	3.438	0.083	7MMW-0400-7-6
7MMW-0600-7-4	6	6.50	5.625	0.109	7MMW-0600-7-6

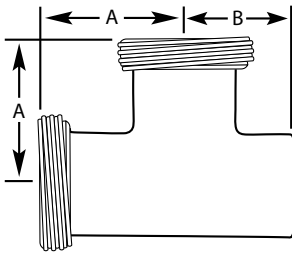
**7WTT****Butt weld x Threaded Bevel Seat Run x Threaded Bevel Seat Branch Tee, #7 Finish 3-A**

304 Item Number	Tube O.D.	A	B	Nominal Wall Thickness	316L Item Number
7WTT-0100-7-4	1	1.812	1.125	0.065	7WTT-0100-7-6
7WTT-0150-7-4	1.5	2.375	1.656	0.065	7WTT-0150-7-6
7WTT-0200-7-4	2	2.781	2.062	0.065	7WTT-0200-7-6
7WTT-0250-7-4	2.5	3.188	2.344	0.065	7WTT-0250-7-6
7WTT-0300-7-4	3	3.500	2.594	0.065	7WTT-0300-7-6
7WTT-0400-7-4	4	4.656	3.438	0.083	7WTT-0400-7-6

7TTW

Threaded Bevel Seat Run x Buttweld Branch Tee, #7 Finish 3-A

304 Item Number	Tube O.D.	A	B	C	Nominal Wall Thickness	316L Item Number
7TTW-0100-7-4	1	1.125	1.812	3.625	0.065	7TTW-0100-7-6
7TTW-0150-7-4	1.5	1.656	2.375	4.748	0.065	7TTW-0150-7-6
7TTW-0200-7-4	2	2.062	2.781	5.562	0.065	7TTW-0200-7-6
7TTW-0250-7-4	2.5	2.344	3.188	6.376	0.065	7TTW-0250-7-6
7TTW-0300-7-4	3	2.594	3.500	7.000	0.065	7TTW-0300-7-6
7TTW-0400-7-4	4	3.438	4.656	9.312	0.083	7TTW-0400-7-6

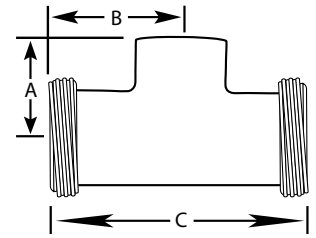

7WTW

Buttweld x Threaded Bevel Seat Run x Buttweld Branch Tee, #7 Finish 3-A

304 Item Number	Tube O.D.	A	B	Nominal Wall Thickness	316L Item Number
7WTW-0100-7-4	1	1.125	1.812	0.065	7WTW-0100-7-6
7WTW-0150-7-4	1.5	1.656	2.375	0.065	7WTW-0150-7-6
7WTW-0200-7-4	2	2.062	2.781	0.065	7WTW-0200-7-6
7WTW-0250-7-4	2.5	2.343	3.188	0.065	7WTW-0250-7-6
7WTW-0300-7-4	3	2.593	3.500	0.065	7WTW-0300-7-6
7WTW-0400-7-4	4	3.438	4.656	0.083	7WTW-0400-7-6

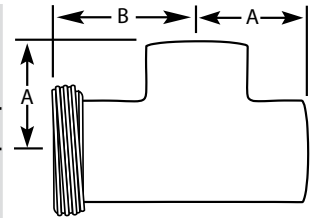

7WWT

Buttweld Run x Threaded Bevel Seat Branch Tee, #7 Finish 3-A

304 Item Number	Tube O.D.	A	B	Nominal Wall Thickness	316L Item Number
7WWT-0100-7-4	1	1.125	1.812	0.065	7WWT-0100-7-6
7WWT-0150-7-4	1.5	1.656	2.375	0.065	7WWT-0150-7-6
7WWT-0200-7-4	2	2.062	2.781	0.065	7WWT-0200-7-6
7WWT-0250-7-4	2.5	2.343	3.188	0.065	7WWT-0250-7-6
7WWT-0300-7-4	3	2.593	3.500	0.065	7WWT-0300-7-6
7WWT-0400-7-4	4	3.438	4.656	0.083	7WWT-0400-7-6

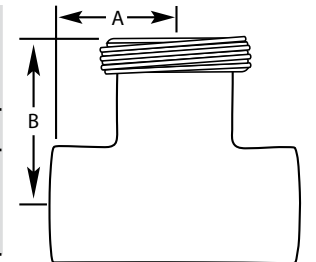

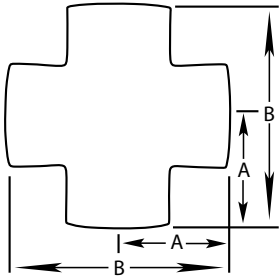

9WWWW

Butt Weld Cross, #7 Finish 3-A

304 Item Number	Tube O.D.	A	B	Nominal Wall Thickness	316L Item Number
9WWWW-0100-7-4	1	1.125	2.250	0.065	9WWWW-0100-7-6
9WWWW-0150-7-4	1.5	1.656	3.312	0.065	9WWWW-0150-7-6
9WWWW-0200-7-4	2	2.062	4.125	0.065	9WWWW-0200-7-6
9WWWW-0250-7-4	2.5	2.343	4.687	0.065	9WWWW-0250-7-6
9WWWW-0300-7-4	3	2.593	5.187	0.065	9WWWW-0300-7-6
9WWWW-0400-7-4	4	3.438	6.875	0.083	9WWWW-0400-7-6
9WWWW-0600-7-4	6	5.625	11.25	0.109	9WWWW-0600-7-6

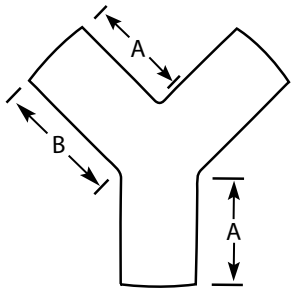

28W

Butt Weld True "Y", #7 Finish 3-A

304 Item Number	Tube O.D.	A	B	Nominal Wall Thickness	316L Item Number
28W-0100-1-4	1	2.000	2.438	0.065	28W-0100-1-6
28W-0150-7-4	1.5	2.000	2.438	0.065	28W-0150-1-6
28W-0200-7-4	2	2.625	3.250	0.065	28W-0200-1-6
28W-0250-7-4	2.5	3.370	4.125	0.065	28W-0250-1-6
28W-0300-7-4	3	4.000	4.875	0.065	28W-0300-1-6
28W-0400-7-4	4	5.375	6.562	0.083	28W-0400-1-6

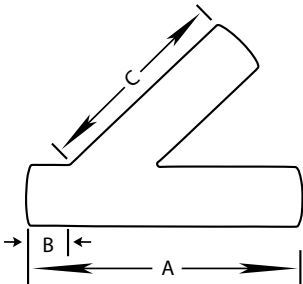

28WA

Butt Weld Lateral "Y", #7 Finish 3-A

304 Item Number	Tube O.D.	A	B	C	Nominal Wall Thickness	316L Item Number
28WA-0100-7-4	1	6.000	1.000	5.000	0.065	28WA-0100-7-6
28WA-0150-7-4	1.5	7.375	1.188	6.188	0.065	28WA-0150-7-6
28WA-0200-7-4	2	8.750	1.625	7.125	0.065	28WA-0200-7-6
28WA-0250-7-4	2.5	10.000	1.500	8.500	0.065	28WA-0250-7-6
28WA-0300-7-4	3	10.750	1.875	8.875	0.065	28WA-0300-7-6
28WA-0400-7-4	4	12.812	2.062	10.750	0.083	28WA-0400-7-6

31W

Butt Weld Concentric Reducer, #7 Finish 3-A

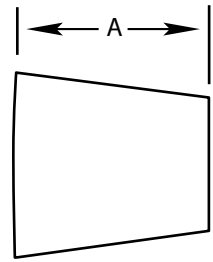

304 Item Number	Tube O.D.	A	Nominal Wall Thickness	316L Item Number
31W-0075X0050-7-4	.75 x.5	1.0	0.065	31W-0075X0050-7-6
31W-0100X0050-7-4	1 x.5	2.0	0.065	31W-0100X0050-7-6
31W-0100X0075-7-4	1 x.75	1.0	0.065	31W-0100X0075-7-6
31W-0150X0050-7-4	1.5 x.5	4.0	0.065	31W-0150X0050-7-6
31W-0150X0075-7-4	1.5 x.75	3.0	0.065	31W-0150X0075-7-6
31W-0150X0100-7-4	1.5 x 1	2.0	0.065	31W-0150X0100-7-6
31W-0150X0125-7-4	1.5 x 1.25	1.0	0.065	31W-0150X0125-7-6
31W-0200X0050-7-4	2 x.5	6.0	0.065	31W-0200X0050-7-6
31W-0200X0075-7-4	2 x.75	5.0	0.065	31W-0200X0075-7-6
31W-0200X0100-7-4	2 x 1	4.0	0.065	31W-0200X0100-7-6
31W-0200X0125-7-4	2 x 1.25	3.0	0.065	31W-0200X0125-7-6
31W-0200X0150-7-4	2 x 1.5	2.0	0.065	31W-0200X0150-7-6
31W-0250X0150-7-4	2.5 x 1.5	4.0	0.065	31W-0250X0150-7-6
31W-0250X0200-7-4	2.5 x 2	2.0	0.065	31W-0250X0200-7-6
31W-0300X0100-7-4	3 x 1	8.0	0.065	31W-0300X0100-7-6
31W-0300X0150-7-4	3 x 1.5	6.0	0.065	31W-0300X0150-7-6
31W-0300X0200-7-4	3 x 2	4.0	0.065	31W-0300X0200-7-6
31W-0300X0250-7-4	3 x 2.5	2.0	0.065	31W-0300X0250-7-6
31W-0400X0150-7-4	4 x 1.5	10.0	0.083/0.065	31W-0400X0150-7-6
31W-0400X0200-7-4	4 x 2	8.0	0.083/0.065	31W-0400X0200-7-6
31W-0400X0250-7-4	4 x 2.5	6.0	0.083/0.065	31W-0400X0250-7-6
31W-0400X0300-7-4	4 x 3	4.0	0.083	31W-0400X0300-7-6
31W-0600X0300-7-4	6 x 3	5.5	0.109	31W-0600X0300-7-6
31W-0600X0400-7-4	6 x 4	5.5	0.109	31W-0600X0400-7-6

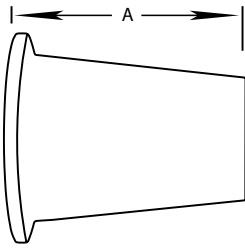
**31M****Clamp x Butt weld Concentric Reducer, #7 Finish 3-A**

304 Item Number	Tube O.D.	A	Nominal Wall Thickness	316L Item Number
31M-0075X0050-7-4	0.75 x 0.5	1.50	0.065	31M-0075X0050-7-6
31M-0100X0050-7-4	1 x 0.5	2.50	0.065	31M-0100X0050-7-6
31M-0100X0075-7-4	1 x .75	1.500	0.065	31M-0100X0075-7-6
31M-0150X0050-7-4	1.5 x 0.5	4.500	0.065	31M-0150X0050-7-6
31M-0150X0075-7-4	1.5 x .75	3.500	0.065	31M-0150X0075-7-6
31M-0150X0100-7-4	1.5 x 1	2.500	0.065	31M-0150X0100-7-6
31M-0200X0100-7-4	2 x 1	4.500	0.065	31M-0200X0100-7-6
31M-0200X0150-7-4	2 x 1.5	2.500	0.065	31M-0200X0150-7-6
31M-0250X0150-7-4	2.5 x 1.5	4.500	0.065	31M-0250X0150-7-6
31M-0250X0200-7-4	2.5 x 2	2.500	0.065	31M-0250X0200-7-6
31M-0300X0150-7-4	3 x 1.5	6.500	0.065	31M-0300X0150-7-6
31M-0300X0200-7-4	3 x 2	4.500	0.065	31M-0300X0200-7-6
31M-0300X0250-7-4	3 x 2.5	2.500	0.065	31M-0300X0250-7-6
31M-0400X0200-7-4	4 x 2	8.625	0.083	31M-0400X0200-7-6
31M-0400X0250-7-4	4 x 2.5	6.625	0.083	31M-0400X0250-7-6
31M-0400X0300-7-4	4 x 3	4.625	0.083	31M-0400X0300-7-6
31M-0600X0300-7-4	6 x 3	5.875	0.109	31M-0600X0300-7-6
31M-0600X0400-7-4	6 x 4	5.875	0.109	31M-0600X0400-7-6

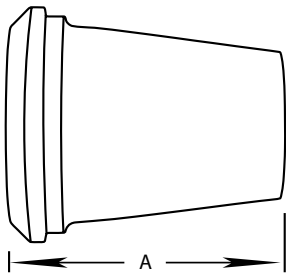
**31P****Plain Bevel Seat x Butt weld Concentric Reducer, #7 Finish 3-A**

304 Item Number	Tube O.D.	A	Nominal Wall Thickness	316L Item Number
31P-0150X0100-7-4	1.5 x 1	2.718	0.065	31P-0150X0100-7-6
31P-0200X0100-7-4	2 x 1	4.718	0.065	31P-0200X0100-7-6
31P-0200X0150-7-4	2 x 1.5	2.718	0.065	31P-0200X0150-7-6
31P-0250X0150-7-4	2.5 x 1.5	4.843	0.065	31P-0250X0150-7-6
31P-0250X0200-7-4	2.5 x 2	2.843	0.065	31P-0250X0200-7-6
31P-0300X0100-7-4	3 x 1	8.906	0.065	31P-0300X0100-7-6
31P-0300X0150-7-4	3 x 1.5	6.906	0.065	31P-0300X0150-7-6
31P-0300X0200-7-4	3 x 2	4.906	0.065	31P-0300X0200-7-6
31P-0300X0250-7-4	3 x 2.5	2.906	0.065	31P-0300X0250-7-6
31P-0400X0150-7-4	4 x 1.5	11.218	0.083	31P-0400X0150-7-6
31P-0400X0200-7-4	4 x 2	9.218	0.083	31P-0400X0200-7-6
31P-0400X0250-7-4	4 x 2.5	7.218	0.083	31P-0400X0250-7-6
31P-0400X0300-7-4	4 x 3	5.218	0.083	31P-0400X0300-7-6

32W

Buttweld Eccentric Reducer, #7 Finish 3-A

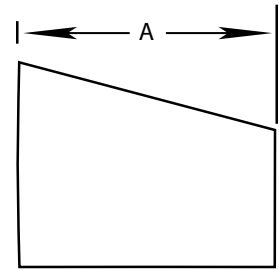

304 Item Number	Tube O.D.	A	Nominal Wall Thickness	316L Item Number
32W-0075X0050-7-4	.75 x.5	1.0	0.065	32W-0075X0050-7-6
32W-0100X0050-7-4	1 x.5	2.0	0.065	32W-0100X0050-7-6
32W-0100X0075-7-4	1 x.75	1.0	0.065	32W-0100X0075-7-6
32W-0150X0050-7-4	1.5 x.5	4.0	0.065	32W-0150X0050-7-6
32W-0150X0075-7-4	1.5 x.75	3.0	0.065	32W-0150X0075-7-6
32W-0150X0100-7-4	1.5 x 1	2.0	0.065	32W-0150X0100-7-6
32W-0200X0050-7-4	2 x.5	6.0	0.065	32W-0200X0050-7-6
32W-0200X0075-7-4	2 x.75	5.0	0.065	32W-0200X0075-7-6
32W-0200X0100-7-4	2 x 1	4.0	0.065	32W-0200X0100-7-6
32W-0200X0150-7-4	2 x 1.5	2.0	0.065	32W-0200X0150-7-6
32W-0250X0100-7-4	2.5 x 1	6.0	0.065	32W-0250X0100-7-6
32W-0250X0150-7-4	2.5 x 1.5	4.0	0.065	32W-0250X0150-7-6
32W-0250X0200-7-4	2.5 x 2	2.0	0.065	32W-0250X0200-7-6
32W-0300X0100-7-4	3 x 1	8.0	0.065	32W-0300X0100-7-6
32W-0300X0150-7-4	3 x 1.5	6.0	0.065	32W-0300X0150-7-6
32W-0300X0200-7-4	3 x 2	4.0	0.065	32W-0300X0200-7-6
32W-0300X0250-7-4	3 x 2.5	2.0	0.065	32W-0300X0250-7-6
32W-0400X0150-7-4	4 x 1.5	10.0	0.083/0.065	32W-0400X0150-7-6
32W-0400X0200-7-4	4 x 2	8.0	0.083/0.065	32W-0400X0200-7-6
32W-0400X0250-7-4	4 x 2.5	6.0	0.083/0.065	32W-0400X0250-7-6
32W-0400X0300-7-4	4 x 3	4.0	0.083/0.065	32W-0400X0300-7-6
32W-0600X0300-7-4	6 x 3	5.5	0.109	32W-0600X0300-7-6
32W-0600X0400-7-4	6 x 4	5.5	0.109	32W-0600X0400-7-6

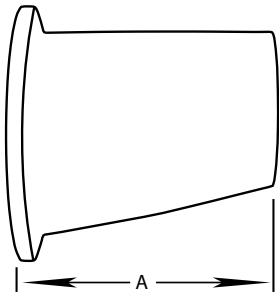
**32M****Clamp x Butt Weld Eccentric Reducers, #7 Finish**

304 Item Number	Tube O.D.	A	Nominal Wall Thickness	316L Item Number
32M-0100X0075-7-4	1 x.75	1.500	0.065	32M-0100X0075-7-6
32M-0150X0075-7-4	1.5 x.75	3.500	0.065	32M-0150X0075-7-6
32M-0150X0100-7-4	1.5 x 1	2.500	0.065	32M-0150X0100-7-6
32M-0200X0100-7-4	2 x 1	4.500	0.065	32M-0200X0100-7-6
32M-0200X0150-7-4	2 x 1.5	2.500	0.065	32M-0200X0150-7-6
32M-0250X0150-7-4	2.5 x 1.5	4.500	0.065	32M-0250X0150-7-6
32M-0250X0200-7-4	2.5 x 2	2.500	0.065	32M-0250X0200-7-6
32M-0300X0150-7-4	3 x 1.5	6.500	0.065	32M-0300X0150-7-6
32M-0300X0200-7-4	3 x 2	4.500	0.065	32M-0300X0200-7-6
32M-0300X0250-7-4	3 x 2.5	2.500	0.065	32M-0300X0250-7-6
32M-0400X0200-7-4	4 x 2	8.625	0.083	32M-0400X0200-7-6
32M-0400X0250-7-4	4 x 2.5	6.625	0.083	32M-0400X0250-7-6
32M-0400X0300-7-4	4 x 3	4.625	0.083	32M-0400X0300-7-6

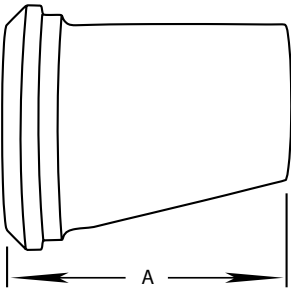
**32P****Plain Bevel Seat x Butt Weld Eccentric Reducer, #7 Finish 3-A**

304 Item Number	Tube O.D.	A	Nominal Wall Thickness	316L Item Number
32P-0150X0100-7-4	1.5 x 1	2.718	0.065	32P-0150X0100-7-6
32P-0200X0100-7-4	2 x 1	4.718	0.065	32P-0200X0100-7-6
32P-0200X0150-7-4	2 x 1.5	2.718	0.065	32P-0200X0150-7-6
32P-0250X0150-7-4	2.5 x 1.5	4.843	0.065	32P-0250X0150-7-6
32P-0250X0200-7-4	2.5 x 2	2.843	0.065	32P-0250X0200-7-6
32P-0300X0100-7-4	3 x 1	8.906	0.065	32P-0300X0100-7-6
32P-0300X0150-7-4	3 x 1.5	6.906	0.065	32P-0300X0150-7-6
32P-0300X0200-7-4	3 x 2	4.906	0.065	32P-0300X0200-7-6
32P-0300X0250-7-4	3 x 2.5	2.906	0.065	32P-0300X0250-7-6
32P-0400X0150-7-4	4 x 1.5	11.218	0.083	32P-0400X0150-7-6
32P-0400X0200-7-4	4 x 2	9.218	0.083	32P-0400X0200-7-6
32P-0400X0250-7-4	4 x 2.5	7.218	0.083	32P-0400X0250-7-6
32P-0400X0300-7-4	4 x 3	5.218	0.083	32P-0400X0300-7-6

14WHR

Buttweld Hose Adapter

304 Item Number	Tube O.D.	A	B	Nominal Wall Thickness	316L Item Number
14WHR-0050-4	.50	1.500	0.50	0.065	14WHR-0050-6
14WHR-0075-4	.75	1.500	0.75	0.065	14WHR-0075-6
14WHR-0100-4	1	1.688	1.00	0.065	14WHR-0100-6
14WHR-0150-4	1.50	1.688	1.50	0.065	14WHR-0150-6
14WHR-0200-4	2	2.312	2.00	0.065	14WHR-0200-6
14WHR-0250-4	2.50	2.000	2.50	0.065	14WHR-0250-6
14WHR-0300-4	3	3.093	3.00	0.065	14WHR-0300-6
14WHR-0400-4	4	3.406	4.00	0.083	14WHR-0400-6

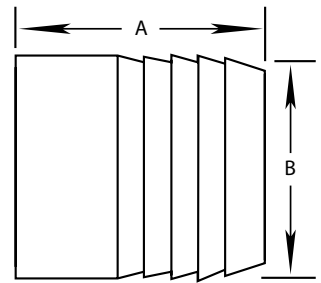

14WHRL

Buttweld Long Hose Adapter

304 Item Number	Tube O.D.	A	B	Nominal Wall Thickness	316L Item Number
14WHRL-0100-4	1	3.000	1.0	0.116	14WHRL-0100-6
14WHRL-0150-4	1.5	4.500	1.5	0.116	14WHRL-0150-6
14WHRL-0200-4	2	4.500	2.0	0.116	14WHRL-0200-6
14WHRL-0250-4	2.5	5.000	2.5	0.116	14WHRL-0250-6
14WHRL-0300-4	3	5.000	3.0	0.116	14WHRL-0300-6
14WHRL-0400-4	4	4.875	4.0	0.116	14WHRL-0400-6

